

**VOLUME 4 SCHEMATIC PLANS AND TECHNICAL
REQUIREMENTS OF A 100-BED HOSPITAL**

4.3 ANCILLARY Service Facility

Hospital: Tertiary, 100-Bed	ROOM DATA SHEET		Department of Health HEALTH INFRASTRUCTURE SERVICE
Updated Reference: May 1992	Department: LABORATORY	Room Title: HEMATOLOGY SECTION	Reference Sheet Number: 100B-AN-RDS14C
TECHNICAL DESIGN DATA:		LAYOUT OF ROOM AND SPACE COMPONENTS:	
DIRECT SERVICES	DESIGN DATA	Scale 1:100 mts.	
Disposal	hospital solid waste type :A,D,G,H		
Hot water	required at sink		
Cold water	required at sink		
Drainage	required at sink		
Gas	NA		
Compressed air	NA		
Steam	NA		
Others			
DIRECT DEMANDS ON FLOOR AND WALL			
Loading	LIGHT : medium : heavy		
Spillage	slight : OCCASIONAL : frequent		
Foot traffic	LIGHT : medium : heavy		
Wheel traffic	NA		
Impacts	NA		
Abrasion	NA		
Easy maintenance	ESSENTIAL: desirable: unnecessary		
Vibration free	ESSENTIAL: desirable: unnecessary		
Door sets	nil, open to circulation		
Windows	clear, solar control		
Internal glazing	nil		
		Key 1. Counter, 900mm high, open below 2. Staining sink 3. Cup sink 4. Counter, 900 mm high below w/adjustable shelves 5. Stool 6. Non-corrosive metal pegboards above drainboards 7. Refrigerator, 8 cu.ft. 8. Micro-hematocrit centrifuge 9. Counter, 900 mm high, drawers and adjustable shelves, below counter 10. Exhaust air grill near floor 11. Blood bank	
		SPACE DEMANDS (Total Minimum Space Required in sq.m.): 18.00	
		Space Components	Minimum Space Required/Component
		REGULATIONS AND NOTES:	

Hospital Tertiary, 100-Bed	ROOM DATA SHEET		Department of Health HEALTH INFRASTRUCTURE SERVICE
Updated Reference: May 1992	Department: LABORATORY	Room Title: BLOOD DONING	Reference Sheet Number: 100B-AN-RDS15B
TECHNICAL DESIGN DATA			
ENVIRONMENTAL CONDITIONS	DESIGN DATA	ENVIRONMENTAL CONDITIONS	DESIGN DATA
AIR		LIGHTING AND VISUAL	
Outdoor air temperature (deg. C)	ave. local station temp. reading	General illumination (LUX)	250
Room Temperature	25	Night illumination (LUX)	NA
Mechanical ventilation		Task illumination (LUX)	1000
Volume (cu.m./hr.-person)	12.75	Colour rendering	essential DESIRABLE unnecessary
Velocity (m/hr.)	900	Standby light	essential DESIRABLE unnecessary
Pressure:		Emergency light	essential DESIRABLE unnecessary
Exhaust (psi)	NA	Daylight	essential desirable UNNECESSARY
Inlet (psi)	NA	View out	essential desirable UNNECESSARY
% Dust filtration	93%-99% @ 1 micron	Privacy	essential DESIRABLE unnecessary
Humidity (%RH)	50	Black out	essential desirable UNNECESSARY
Cooling load (TR)	0.75		
SOUND		SAFETY	
Acceptable sound level (db)	50	Accessible hot surface	NA
Speech privacy	essential DESIRABLE unnecessary	Maximum temperature (deg. C)	NA
Quality which cannot be tolerated	tonal impact	Domestic hot water	NA
		Maximum temperature (deg. C)	NA
		Access limit	laboratory staff & blood donors
		Fire risk	LOW medium high
		Other risks	NA

Hospital: Tertiary, 100-Bed	ROOM DATA SHEET		Department of Health HEALTH INFRASTRUCTURE SERVICE
Updated Reference: May 1992	Department: LABORATORY	Room Title: WAITING AREA	Reference Sheet Number: 100B-AN-RDS16A

FUNCTIONAL DESIGN REQUIREMENTS:

<p>This activity space provides facilities needed for the following activities:</p> <ul style="list-style-type: none"> a. Patients await their turns to be examined/attended to by Medical Laboratory Aide. b. Patients/Donors await their turns for their blood to be extracted. c. Patients await the release of their examination results. <p>People involved:</p> <ul style="list-style-type: none"> 1 x Medical Laboratory Aide Patients Blood Donors <p>Planning Relationships:</p> <ul style="list-style-type: none"> a. Close to Blood Doning Room. b. Close to Pathologist's Office. 	EQUIPMENT AND ACCESSORY CHECKLIST	QUANTITY	REMARKS
	FURNITURE AND FIXTURE CHECKLIST	QUANTITY	REMARKS
	Desk, 750 x 1200 Swivel chair Chair, upright, stacking Steel filing cabinet, 500x700 Bench, 400 x 1500 Counter, 900 mm high, cabinets below Lavatory Water closet	1 1 2 2 3 1 1	
ADDITIONAL EQUIPMENT AND ENGINEERING TERMINALS	QUANTITY	REMARKS	
	1 3	grounding type, parallel slots	

Hospital Tertiary, 100-Bed	ROOM DATA SHEET		Department of Health HEALTH INFRASTRUCTURE SERVICE
Updated Reference: May 1992	Department: LABORATORY	Room Title: WAITING AREA	Reference Sheet Number: 100B-AN-RDS16B
TECHNICAL DESIGN DATA			
ENVIRONMENTAL CONDITIONS	DESIGN DATA	ENVIRONMENTAL CONDITIONS	DESIGN DATA
AIR		LIGHTING AND VISUAL	
Outdoor air temperature (deg. C)	ave. local station temp. reading	General illumination (LUX)	150
Room Temperature	ambient	Night illumination (LUX)	50
Mechanical ventilation		Task illumination (LUX)	NA
Volume (cu m./hr.-person)	NA	Colour rendering	essential: desirable: UNNECESSARY
Velocity (m/hr.)	NA	Standby light	essential: DESIRABLE : unnecessary
Pressure		Emergency light	essential: DESIRABLE: unnecessary
Exhaust (psi)	NA	Daylight	essential: desirable: UNNECESSARY
Inlet (psi)	NA	View out	essential: desirable: UNNECESSARY
% Dust filtration	NA	Privacy	essential: desirable: UNNECESSARY
Humidity (%RH)	NA	Black out	essential: desirable: UNNECESSARY
Cooling load (TR)	NA		
SOUND		SAFETY	
Acceptable sound level (db)	50	Accessible hot surface:	NA
Speech privacy	essential: desirable: UNNECESSARY	Maximum temperature (deg. C)	NA
Quality which cannot be tolerated	NA	Domestic hot water:	NA
		Maximum temperature (deg. C)	NA
		Access limit	laboratory staff & general public
		Fire risk	LOW: medium: high
		Other risks	NA

Hospital: Tertiary, 100-Bed	ROOM DATA SHEET		Department of Health HEALTH INFRASTRUCTURE SERVICE
Updated Reference: May 1992	Department: LABORATORY	Room Title: WAITING AREA	Reference Sheet Number: 100B-AN-RDS16C
TECHNICAL DESIGN DATA:		LAYOUT OF ROOM AND SPACE COMPONENTS:	
DIRECT SERVICES	DESIGN DATA	<p style="text-align: right;">Scale 1:100 mts.</p> <p>Key</p> <p>1. Desk, 750 x 1200 2. Swivel chair 3. Chair, upright, stacking 4. Steel filing cabinet, 500x700 5. Bench, 400 x 1500 6. Counter, 900 mm high, cabinets below</p>	
Disposal	hospital solid waste type : A		
Hot water	NA		
Cold water	required at toilet fixtures		
Drainage	required at toilet fixtures & floor		
Gas	NA		
Compressed air	NA		
Steam	NA		
Others			
DIRECT DEMANDS ON FLOOR AND WALL			
Loading	NA		
Spillage	NA		
Foot traffic	light : medium : HEAVY		
Wheel traffic	light : MEDIUM : heavy		
Impacts	NA		
Abrasion	NA		
Easy maintenance	ESSENTIAL: desirable: unnecessary		
Vibration free	essential: DESIRABLE: unnecessary		
Door sets	wheelchair access	SPACE DEMANDS (Total Minimum Space Required in sq.m.): 30.50	
		Space Components	Minimum Space Required/Component
Windows	clear, solar control	Waiting Area	28.26 sq.m.
		Toilet	2.24 sq.m.
Internal glazing	nil	REGULATIONS AND NOTES:	

Hospital: Tertiary, 100-Bed	ROOM DATA SHEET		Department of Health HEALTH INFRASTRUCTURE SERVICE
Updated Reference: May 1992	Department: LABORATORY	Room Title: PATHOLOGIST'S OFFICE	Reference Sheet Number: 100B-AN-RDS17A

FUNCTIONAL DESIGN REQUIREMENTS:

<p>This activity space provides facilities needed for the following activities:</p> <ul style="list-style-type: none"> a. Pathologist reads, writes and uses telephone in his desk. b. Pathologist stores, files and retrieves records. c. Pathologist receives visitors. <p>People Involved:</p> <ul style="list-style-type: none"> 1 x Pathologist Visitors <p>Planning Relationships:</p> <ul style="list-style-type: none"> a. Close to Waiting Area. b. Close to Hematology Section. 	EQUIPMENT AND ACCESSORY CHECKLIST	QUANTITY	REMARKS
	FURNITURE AND FIXTURE CHECKLIST	QUANTITY	REMARKS
	Desk, 750 x 1200 Swivel chair Chair, upright, stacking Counter, 900 mm high, cabinets below Sofa, 750 x 2000 Steel filing cabinet, 500x700 Lavatory Water closet	1 1 2 1 2 1 1	
	ADDITIONAL EQUIPMENT AND ENGINEERING TERMINALS	QUANTITY	REMARKS
	Rail, curtain, window Outlet, intercom Outlet, 10A, 2P, 240V, duplex Outlet, 15A, 2P, 240V, single Outlet, telephone Smoke detector	1 1 3 1 1 1	 grounding type, parallel slots grounding type, tandem slots

Hospital		ROOM DATA SHEET		Department of Health	
Tertiary, 100-Bed				HEALTH INFRASTRUCTURE SERVICE	
Updated Reference: May 1992		Department: LABORATORY	Room Title: PATHOLOGIST'S OFFICE	Reference Sheet Number: 100B-AN-RDS17B	
TECHNICAL DESIGN DATA:					
ENVIRONMENTAL CONDITIONS		DESIGN DATA		ENVIRONMENTAL CONDITIONS	
				DESIGN DATA	
AIR			LIGHTING AND VISUAL		
Outdoor air temperature (deg. C)		ave. local station temp. reading	General illumination (LUX)	250-500	
Room Temperature		25	Night illumination (LUX)	NA	
Mechanical ventilation			Task illumination (LUX)	NA	
Volume (cu.m./hr./person)		12.75	Colour rendering	essential DESIRABLE unnecessary	
Velocity (m/hr.)		750	Standby light	essential DESIRABLE unnecessary	
Pressure:			Emergency light	essential desirable UNNECESSARY	
Exhaust (psi)		NA	Daylight	essential DESIRABLE unnecessary	
Inlet (psi)		NA	View out	essential DESIRABLE unnecessary	
% Dust filtration		93% - 99% @ 1 micron	Privacy	ESSENTIAL desirable unnecessary	
Humidity (%RH)		50	Black out	essential desirable UNNECESSARY	
Cooling load (TR)		1			
SOUND			SAFETY		
Acceptable sound level (db)		40	Accessible hot surface	NA	
Speech privacy		essential DESIRABLE unnecessary	Maximum temperature (deg. C)	NA	
Quality which cannot be tolerated		NA	Domestic hot water:	at lavatory	
			Maximum temperature (deg. C)	70	
			Access limit	pathologist and visitors	
			Fire risk	LOW : medium : high	
			Other risks	NA	

Hospital:	ROOM DATA SHEET		Department of Health HEALTH INFRASTRUCTURE SERVICE
Tertiary, 100-Bed			
Updated Reference: May 1992	Department: LABORATORY	Room Title: PATHOLOGIST'S OFFICE	Reference Sheet Number: 100B-AN-RDS17C
TECHNICAL DESIGN DATA:		LAYOUT OF ROOM AND SPACE COMPONENTS:	
DIRECT SERVICES	DESIGN DATA	<p style="text-align: right;">Scale 1:100 mts.</p>	
Disposal	hospital solid waste type : A		
Hot water	required at lavatory		
Cold water	required at toilet fixtures		
Drainage	required at toilet fixtures & floor		
Gas	NA		
Compressed air	NA		
Steam	NA		
Others			
DIRECT DEMANDS ON FLOOR AND WALL			
Loading	NA		
Spillage	NA		
Foot traffic	LIGHT : medium : heavy		
Wheel traffic	LIGHT : medium : heavy		
Impacts	NA		
Abrasion	NA		
Easy maintenance	ESSENTIAL : desirable:unnecessary	SPACE DEMANDS (Total Minimum Space Required in sq.m.): 16.00	
Vibration free	ESSENTIAL : desirable: unnecessary	Space Components	Minimum Space Required/Component
Door set	wheelchair access	Office Area	13.76 sq.m.
Windows	clear,solar control	Toilet	2.24 sq.m.
Internal glazing	nil	REGULATIONS AND NOTES:	

Hospital: Tertiary, 100-Bed	ROOM DATA SHEET		Department of Health HEALTH INFRASTRUCTURE SERVICE
Updated Reference: May 1992	Department: LABORATORY	Room Title: STAFF AREA	Reference Sheet Number: 100B-AN-RDS18A
FUNCTIONAL DESIGN REQUIREMENTS:			
<p>This activity space provides facilities needed for the following activities:</p> <ul style="list-style-type: none"> a. Laboratory staff reads and writes in his work station. b. Laboratory staff receives visitors. c. Laboratory staff stores, files and retrieves records. d. Laboratory aide uses typewriter. <p>People Involved:</p> <ul style="list-style-type: none"> 3 x Medical technologist 2 x Medical Laboratory Aide Visitors <p>Planning Relationships:</p> <ul style="list-style-type: none"> a. Close to Pathologist's Office. b. Close to Waiting Area. 	EQUIPMENT AND ACCESSORY CHECKLIST	QUANTITY	REMARKS
	FURNITURE AND FIXTURE CHECKLIST	QUANTITY	REMARKS
	Desk, 750 x 1200 Chair, upright, stacking Typewriter table, 400 x 800 Bench, 400 x 1500 Shelves Steel filing cabinet, 500 x 700	4 5 1 1 4	
ADDITIONAL EQUIPMENT AND ENGINEERING TERMINALS	QUANTITY	REMARKS	
	1 6 2 1	grounding type, parallel slots grounding type, tandem slots	

Hospital	ROOM DATA SHEET		Department of Health HEALTH INFRASTRUCTURE SERVICE
Tertiary, 100-Bed			
Updated Reference: May 1992	Department: LABORATORY	Room Title: STAFF AREA	Reference Sheet Number: 100B-AN-RDS18B
TECHNICAL DESIGN DATA:			
ENVIRONMENTAL CONDITIONS	DESIGN DATA	ENVIRONMENTAL CONDITIONS	DESIGN DATA
AIR		LIGHTING AND VISUAL	
Outdoor air temperature (deg. C)	ave. local station temp. reading	General illumination (LUX)	250-500
Room Temperature	25	Night illumination (LUX)	NA
Mechanical ventilation		Task illumination (LUX)	NA
Volume (cu.m./hr.-person)	12.75	Colour rendering	essential: desirable UNNECESSARY
Velocity (m.hr.)	900	Standby light	essential: DESIRABLE: unnecessary
Pressure:		Emergency light	essential: DESIRABLE: unnecessary
Exhaust (psi)	NA	Daylight	essential: DESIRABLE: unnecessary
Inlet (psi)	NA	View out	essential: DESIRABLE: unnecessary
% Dust filtration	93% - 99% @ 1 micron	Privacy	essential: DESIRABLE: unnecessary
Humidity (%RH)	50	Black out	essential: desirable: UNNECESSARY
Cooling load (TR)	2		
SOUND		SAFETY	
Acceptable sound level (db)	50	Accessible hot surface:	NA
Speech privacy:	essential: DESIRABLE: unnecessary	Maximum temperature (deg. C)	NA
Quality which cannot be:	tonal impact	Domestic hot water:	NA
tolerated		Maximum temperature (deg. C)	NA
		Access limit	laboratory staff and visitors
		Fire risk	LOW: medium: high
		Other risks	NA

Hospital: Tertiary, 100-Bed	ROOM DATA SHEET		Department of Health HEALTH INFRASTRUCTURE SERVICE										
Updated Reference: May 1992	Department: LABORATORY	Room Title: STAFF AREA	Reference Sheet Number: 100B-AN-RDS18C										
TECHNICAL DESIGN DATA:		LAYOUT OF ROOM AND SPACE COMPONENTS:											
DIRECT SERVICES	DESIGN DATA	<p style="text-align: right;">Scale 1:100 mts.</p>											
Disposal	hospital solid waste type : A												
Hot water	NA												
Cold water	NA												
Drainage	NA												
Gas	NA												
Compressed air	NA												
Steam	NA												
Others													
DIRECT DEMANDS ON FLOOR AND WALL													
Loading	LIGHT : medium : heavy												
Spillage	NA												
Foot traffic	light : MEDIUM : heavy												
Wheel traffic	LIGHT : medium : heavy												
Impacts	NA												
Abrasion	NA												
Easy maintenance	ESSENTIAL: desirable: unnecessary												
Vibration free	ESSENTIAL: desirable: unnecessary												
Door set	ordinary access door												
Windows	clear												
Internal glazing	nil												
		<p>Key</p> <p>1. Desk, 750 x 1200 4. Bench, 400 x 1500 2. Chair, upright, stacking 5. Shelves 3. Typewriter table, 400x800 6. Steel filing cabinet, 500 x 700</p>											
		<p>SPACE DEMANDS (Total Minimum Space Required in sq.m.):28.00</p> <table border="1"> <thead> <tr> <th>Space Components</th> <th>Minimum Space Required/Component</th> </tr> </thead> <tbody> <tr><td> </td><td> </td></tr> <tr><td> </td><td> </td></tr> <tr><td> </td><td> </td></tr> <tr><td> </td><td> </td></tr> </tbody> </table>		Space Components	Minimum Space Required/Component								
Space Components	Minimum Space Required/Component												
		<p>REGULATIONS AND NOTES:</p>											

Hospital: Tertiary, 100-Bed	ROOM DATA SHEET		Department of Health HEALTH INFRASTRUCTURE SERVICE
Updated Reference: May 1992	Department: LABORATORY	Room Title: GLASS WASHING AND STERILIZING	Reference Sheet Number: 100B-AN-RDS19A
FUNCTIONAL DESIGN REQUIREMENTS:			
<p>This activity space provides facilities needed for the following activities:</p> <ul style="list-style-type: none"> a. Washing of instrument/glasswares. b. Sterilization of instrument/glasswares. c. Preparation of glassware/instrument for future use. <p>People Involved:</p> <p>1 x Laboratory Service</p> <p>Planning Relationships:</p> <ul style="list-style-type: none"> a. Close to Locker Room & Toilet b. Close to Storage 	EQUIPMENT AND ACCESSORY CHECKLIST	QUANTITY	REMARKS
	Two compartment sink, 200mm deep	1	
	Laboratory pressure sterilizer	1	
	Hot air oven	1	
Water still, 2-5 gal./hr.	1		
Analytical balance	1		
Exhaust hood	1		
	FURNITURE AND FIXTURE CHECKLIST	QUANTITY	REMARKS
	Storage cabinet	2	
	ADDITIONAL EQUIPMENT AND ENGINEERING TERMINALS	QUANTITY	REMARKS
	Outlet, 10A, 2P, 240V, duplex	3	grounding type, parallel slots grounding type, tandem slots
	Outlet, 15A, 2P, 240V, single	4	

Hospital Tertiary, 100-Bed	ROOM DATA SHEET		Department of Health HEALTH INFRASTRUCTURE SERVICE
Updated Reference: May 1992	Department: LABORATORY	Room Title: GLASS WASHING AND STERILIZING	Reference Sheet Number: 100B-AN-RDS19B
TECHNICAL DESIGN DATA:			
ENVIRONMENTAL CONDITIONS	DESIGN DATA	ENVIRONMENTAL CONDITIONS	DESIGN DATA
AIR		LIGHTING AND VISUAL	
Outdoor air temperature (deg. C)	ave. local station temp. reading	General illumination (LUX)	500
Room Temperature	atmospheric	Night illumination (LUX)	NA
Mechanical ventilation		Task illumination (LUX)	NA
Volume (cu.m./hr.-person)	NA	Colour rendering	ESSENTIAL: desirable: unnecessary
Velocity (m.hr.)	NA	Standby light	essential: DESIRABLE: unnecessary
Pressure	NA	Emergency light	essential: DESIRABLE: unnecessary
Exhaust (psi)	NA	Daylight	essential: DESIRABLE: unnecessary
Inlet (psi)	NA	View out	essential: desirable: UNNECESSARY
% Dust filtration	NA	Privacy	essential: desirable: UNNECESSARY
Humidity (%RH)	NA	Black out	essential: desirable: UNNECESSARY
Cooling load (TR)	NA		
SOUND		SAFETY	
Acceptable sound level (db)	60	Accessible hot surface:	pressure sterilizer
Speech privacy	essential: desirable: UNNECESSARY	Maximum temperature (deg. C)	100
Quality which cannot be tolerated	NA	Domestic hot water:	at sink
		Maximum temperature (deg. C)	70
		Access limit	laboratory staff
		Fire risk	low: MEDIUM: high
		Other risks	NA

Hospital: Tertiary, 100-Bed	ROOM DATA SHEET		Department of Health HEALTH INFRASTRUCTURE SERVICE																								
Updated Reference: May 1992	Department: LABORATORY	Room Title: GLASS WASHING AND STERILIZING	Reference Sheet Number: 100B-AN-RDS19C																								
TECHNICAL DESIGN DATA:		LAYOUT OF ROOM AND SPACE COMPONENTS:																									
<table border="1"> <thead> <tr> <th>DIRECT SERVICES</th> <th>DESIGN DATA</th> </tr> </thead> <tbody> <tr> <td>Disposal</td> <td>hospital solid waste type : A,D,F</td> </tr> <tr> <td>Hot water</td> <td>required at sink</td> </tr> <tr> <td>Cold water</td> <td>required at sink</td> </tr> <tr> <td>Drainage</td> <td>required at sink and floor</td> </tr> <tr> <td>Gas</td> <td>NA</td> </tr> <tr> <td>Compressed air</td> <td>NA</td> </tr> <tr> <td>Steam</td> <td>NA</td> </tr> <tr> <td>Others</td> <td></td> </tr> </tbody> </table>		DIRECT SERVICES	DESIGN DATA	Disposal	hospital solid waste type : A,D,F	Hot water	required at sink	Cold water	required at sink	Drainage	required at sink and floor	Gas	NA	Compressed air	NA	Steam	NA	Others		Scale 1:100 mts.							
DIRECT SERVICES	DESIGN DATA																										
Disposal	hospital solid waste type : A,D,F																										
Hot water	required at sink																										
Cold water	required at sink																										
Drainage	required at sink and floor																										
Gas	NA																										
Compressed air	NA																										
Steam	NA																										
Others																											
<table border="1"> <thead> <tr> <th colspan="2">DIRECT DEMANDS ON FLOOR AND WALL</th> </tr> </thead> <tbody> <tr> <td>Loading</td> <td>LIGHT : medium : heavy</td> </tr> <tr> <td>Spillage</td> <td>slight : occasional: FREQUENT</td> </tr> <tr> <td>Foot traffic</td> <td>light : MEDIUM : heavy</td> </tr> <tr> <td>Wheel traffic</td> <td>NA</td> </tr> <tr> <td>Impacts</td> <td>NA</td> </tr> <tr> <td>Abrasion</td> <td>NA</td> </tr> <tr> <td>Easy maintenance</td> <td>ESSENTIAL: desirable: unnecessary</td> </tr> <tr> <td>Vibration free</td> <td>ESSENTIAL: desirable: unnecessary</td> </tr> <tr> <td>Door sets</td> <td>ordinary access door</td> </tr> <tr> <td>Windows</td> <td>clear</td> </tr> <tr> <td>Internal glazing</td> <td>nil</td> </tr> </tbody> </table>		DIRECT DEMANDS ON FLOOR AND WALL		Loading	LIGHT : medium : heavy	Spillage	slight : occasional: FREQUENT	Foot traffic	light : MEDIUM : heavy	Wheel traffic	NA	Impacts	NA	Abrasion	NA	Easy maintenance	ESSENTIAL: desirable: unnecessary	Vibration free	ESSENTIAL: desirable: unnecessary	Door sets	ordinary access door	Windows	clear	Internal glazing	nil		
DIRECT DEMANDS ON FLOOR AND WALL																											
Loading	LIGHT : medium : heavy																										
Spillage	slight : occasional: FREQUENT																										
Foot traffic	light : MEDIUM : heavy																										
Wheel traffic	NA																										
Impacts	NA																										
Abrasion	NA																										
Easy maintenance	ESSENTIAL: desirable: unnecessary																										
Vibration free	ESSENTIAL: desirable: unnecessary																										
Door sets	ordinary access door																										
Windows	clear																										
Internal glazing	nil																										
		<p>Key</p> <p>1. Two compartment sink, 200mm deep 5. water still, 2-5 gal/hr. 2. Storage cabinet 6. Analytical balance 3. Laboratory pressure sterilizer 7. Exhaust hood 4. Hot air oven</p>																									
		SPACE DEMANDS (Total Minimum Space Required in sq.m.): 21.00																									
		Space Components	Minimum Space Required/Component																								
		REGULATIONS AND NOTES:																									

Hospital	ROOM DATA SHEET		Department of Health HEALTH INFRASTRUCTURE SERVICE
Tertiary, 100-Bed			
Updated Reference: November 1991	Department: LABORATORY	Room Title: STORAGE ROOM	Reference Sheet Number: 100B-AN-RDS20B
TECHNICAL DESIGN DATA:			
ENVIRONMENTAL CONDITIONS	DESIGN DATA	ENVIRONMENTAL CONDITIONS	DESIGN DATA
AIR		LIGHTING AND VISUAL	
Outdoor air temperature (deg. C)	ave. local station temp. reading	General illumination (LUX)	150
Room Temperature	ambient	Night illumination (LUX)	NA
Mechanical ventilation		Task illumination (LUX)	NA
Volume (cu.m./hr.-person)	NA	Colour rendering	essential: DESIRABLE: unnecessary
Velocity (m/hr.)	NA	Standby light	essential: desirable: UNNECESSARY
Pressure		Emergency light	essential: desirable: UNNECESSARY
Exhaust (psi)	NA	Daylight	essential: desirable: UNNECESSARY
Inlet (psi)	NA	View out	essential: desirable: UNNECESSARY
% Dust filtration	NA	Privacy	essential: desirable: UNNECESSARY
Humidity (%RH)	NA	Black out	essential: desirable: UNNECESSARY
Cooling load (TR)	NA		
SOUND		SAFETY:	
Acceptable sound level (db)	60	Accessible hot surface:	NA
Speech privacy	essential: desirable: UNNECESSARY	Maximum temperature (deg. C)	NA
Quality which cannot be	NA	Domestic hot water:	NA
tolerated.		Maximum temperature (deg. C)	NA
		Access limit	laboratory staff
		Fire risk	LOW: medium: high
		Other risks	NA

Hospital: Tertiary, 100-Bed	ROOM DATA SHEET		Department of Health HEALTH INFRASTRUCTURE SERVICE
Updated Reference: May 1992	Department: LABORATORY	Room Title: STORAGE ROOM	Reference Sheet Number: 100B-AN-RDS20C
TECHNICAL DESIGN DATA:		LAYOUT OF ROOM AND SPACE COMPONENTS:	
DIRECT SERVICES	DESIGN DATA	Scale 1:100 mts.	
Disposal	hospital solid waste type : A		
Hot water	NA		
Cold water	NA		
Drainage	NA		
Gas	NA		
Compressed air	NA		
Steam	NA		
Others			
DIRECT DEMANDS ON FLOOR AND WALL			
Loading	light : MEDIUM : heavy		
Spillage	slight : OCCASIONAL : frequent		
Foot traffic	LIGHT : medium : heavy		
Wheel traffic	LIGHT : medium : heavy		
Impacts	NA		
Abrasion	NA		
Easy maintenance	ESSENTIAL : desirable unnecessary	SPACE DEMANDS (Total Minimum Space Required in sq.m.) : 7.00	
Vibration free	ESSENTIAL : desirable unnecessary	Space Components	Minimum Space Required/Component
Door set	ordinary access door		
Windows	clear	REGULATIONS AND NOTES	
Internal glazing	nil		

Hospital: Tertiary, 100-Bed	ROOM DATA SHEET		Department of Health HEALTH INFRASTRUCTURE SERVICE
Updated Reference: May 1992	Department: LABORATORY	Room Title: LOCKER ROOM AND TOILET	Reference Sheet Number: 100B-AN-RDS21A
FUNCTIONAL DESIGN REQUIREMENTS:			
<p>This activity space provides facilities needed for the following activities:</p> <ul style="list-style-type: none"> a. Laboratory staff to change clothes in toilet & locker room b. laboratory staff to bathe in toilet. c. Storing of clothing & personal effects. <p>People Involved</p> <p>Medical Technologists Medical Laboratory Technicians Laboratory Aides</p> <p>Planning Relationships:</p> <ul style="list-style-type: none"> a. Close to Glasswashing & Sterilizing Room 	EQUIPMENT AND ACCESSORY CHECKLIST	QUANTITY	REMARKS
	FURNITURE AND FIXTURE CHECKLIST	QUANTITY	REMARKS
	Locker, 500x600 Water closet Lavatory	6 2 2	
	ADDITIONAL EQUIPMENT AND ENGINEERING TERMINALS	QUANTITY	REMARKS
	Rail, curtain, window Outlet, 10A, 2P, 240V, duplex	1 2	grounding type parallel slots

Hospital: Tertiary, 100-Bed	ROOM DATA SHEET		Department of Health HEALTH INFRASTRUCTURE SERVICE
Updated Reference: May 1992	Department: LABORATORY	Room Title: LOCKER ROOM AND TOILET	Reference Sheet Number: 100B-AN-RDS20B
TECHNICAL DESIGN DATA:			
ENVIRONMENTAL CONDITIONS	DESIGN DATA	ENVIRONMENTAL CONDITIONS	DESIGN DATA
AIR:		LIGHTING AND VISUAL	
Outdoor air temperature (deg.C)	ave. local station temp. reading	General illumination (LUX)	150
Room Temperature (deg. C)	ambient	Night illumination (LUX)	NA
Mechanical ventilation:		Task illumination (LUX)	NA
Volume (cu.m./hr.-person)	NA	Colour rendering	essential : desirable : UNNECESSARY
Velocity (m./hr.)	NA	Standby light	essential : DESIRABLE : unnecessary
Pressure:		Emergency light	essential : desirable : UNNECESSARY
Exhaust (psi)	NA	Daylight	essential : DESIRABLE : unnecessary
Inlet (psi)	NA	View out	essential : desirable : UNNECESSARY
%Dust filtration	NA	Privacy	essential : DESIRABLE : unnecessary
Humidity (%RH)	NA	Black out	essential : desirable : UNNECESSARY
Cooling load (TR)	NA		
SOUND			
Acceptable sound level (db)	50	SAFETY	
Speech privacy	essential : desirable : UNNECESSARY	Accessible hot surface:	NA
Quality which cannot be tolerated	tonal impact	Maximum temperature (deg. C)	NA
		Domestic hot water:	NA
		Maximum temperature (deg. C)	NA
		Access limit	laboratory staff
		Fire risk	LOW : medium : high
		Other risk	NA

Hospital: Tertiary, 100-Bed	DEPARTMENT DATA SHEET	Department of Health HEALTH INFRASTRUCTURE SERVICE
Updated Reference: May 1992	Department: PHARMACY	Reference Sheet Number: 100B-AN-DDS03

LAYOUT PER DEPARTMENT SHOWING ROOMS AND SPACE COMPONENTS:

Scale 1:150 mts.

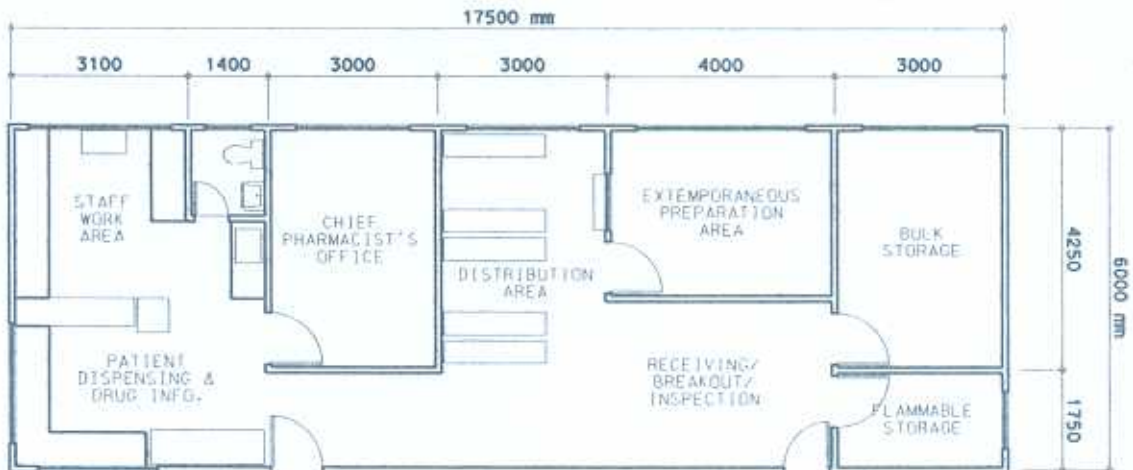

Hospital: Tertiary, 100-Bed	ROOM DATA SHEET		Department of Health HEALTH INFRASTRUCTURE SERVICE
Updated Reference: May 1992	Department: PHARMACY	Room Title: CHIEF PHARMACIST'S OFFICE	Reference Sheet Number: 100B-AN-RDS22A

FUNCTIONAL DESIGN REQUIREMENTS:

<p>This activity space provides facilities needed for the following activities:</p> <ul style="list-style-type: none"> a. Pharmacist reads, writes and uses intercom in his desk b. Pharmacist stores, files and retrieves records. c. Pharmacist receives visitors. d. Pharmacist develops policies. e. Pharmacist plans and coordinates activities. f. Pharmacist requisitions drugs and medicines for actual procurements. <p>People Involved:</p> <p>1 x Pharmacist</p> <p>Planning Relationships:</p> <ul style="list-style-type: none"> a. Close to Distribution Area. b. Close to Patient Dispensing Area. e. Close to Staff Area. 	EQUIPMENT AND ACCESSORY CHECKLIST	QUANTITY	REMARKS
	Calculating machine	1	
	FURNITURE AND FIXTURE CHECKLIST	QUANTITY	REMARKS
	Desk, 750x1500 Swivel chair Chair, upright, stacking Steel filing cabinet, 500x700 Book shelf, 300x1500	1 1 2 2 1	
	ADDITIONAL EQUIPMENT AND ENGINEERING TERMINALS	QUANTITY	REMARKS
	Rail, curtain, window Outlet, intercom Outlet, 10A, 2P, 240V, duplex Outlet, 15A, 2P, 240V, single Smoke detector Outlet, telephone	1 1 3 1 1 1	grounding type, parallel slots grounding type tandem, slots

Hospital: Tertiary, 100-Bed	ROOM DATA SHEET		Department of Health HEALTH INFRASTRUCTURE SERVICE
Updated Reference: May 1992	Department: PHARMACY	Room Title: CHIEF PHARMACIST'S OFFICE	Reference Sheet Number: 100B-AN-RDS22B
TECHNICAL DESIGN DATA:			
ENVIRONMENTAL CONDITIONS	DESIGN DATA	ENVIRONMENTAL CONDITIONS	DESIGN DATA
AIR		LIGHTING AND VISUAL	
Outdoor air temperature (deg.C)	ave. local station temp. reading	General illumination (LUX)	500
Room Temperature (deg. C)	25	Night illumination (LUX)	NA
Mechanical ventilation:		Task illumination (LUX)	NA
Volume (cu.m./hr.-person)	12.75	Colour rendering	essential : DESIRABLE : unnecessary
Velocity (m./hr.)	750	Standby light	essential : DESIRABLE : unnecessary
Pressure:		Emergency light	essential : DESIRABLE : unnecessary
Exhaust (psi)	NA	Daylight	essential : desirable : UNNECESSARY
Inlet (psi)	NA	View out	essential : DESIRABLE : unnecessary
%Dust filtration	93% - 99% @ 1 micron	Privacy	essential : DESIRABLE : unnecessary
Humidity (%RH)	50	Black out	essential : desirable : UNNECESSARY
Cooling load (TR)	1		
SOUND			
Acceptable sound level (db)	40	SAFETY	
Speech privacy	essential: DESIRABLE: unnecessary	Accessible hot surface:	NA
Quality which cannot be tolerated	NA	Maximum temperature (deg. C)	NA
		Domestic hot water:	NA
		Maximum temperature (deg. C)	NA
		Access limit	pharmacist, hosp. staff & visitors
		Fire risk	LOW : medium : high
		Other risks	NA

Hospital: Tertiary, 100-Bed	ROOM DATA SHEET		Department of Health HEALTH INFRASTRUCTURE SERVICE
Updated Reference: May 1992	Department: PHARMACY	Room Title: CHIEF PHARMACIST'S OFFICE	Reference Sheet Number: 100B-AN-RDS22C
TECHNICAL DESIGN DATA:		LAYOUT OF ROOM AND SPACE COMPONENTS:	
DIRECT SERVICES	DESIGN DATA	Scale 1:100 mts.	
Disposal	hospital solid waste type : A		
Hot water	NA		
Cold water	NA		
Drainage	NA		
Gas	NA		
Compressed air	NA		
Steam	NA		
Others			
DIRECT DEMANDS ON FLOOR AND WALL			
Loading	NA		
Spillage	NA		
Foot traffic	LIGHT : medium : heavy		
Wheel traffic	LIGHT : medium : heavy		
Impacts	NA		
Abrasion	NA		
Easy maintenance	ESSENTIAL: desirable: unnecessary	Key 1. Desk, 750x1500 2. Swivel chair 3. Chair, upright, stacking 4. Steel filing cabinet, 500x700 5. Cabinet, 900mm high, 600x1500 6. Book shelf, 300x1500	
Vibration free	ESSENTIAL: desirable: unnecessary		
Door set	wheelchair access	SPACE DEMANDS (Total Minimum Space Required in sq.m.): 12.75	
Windows	clear, solar control, privacy		
	control	REGULATIONS AND NOTES:	
Internal glazing	nil		
		Space Components	Minimum Space Required/Component

Hospital: Tertiary, 100-Bed	ROOM DATA SHEET		Department of Health HEALTH INFRASTRUCTURE SERVICE
Updated Reference: May 1992	Department: PHARMACY	Room Title: STAFF WORK AREA	Reference Sheet Number: 100B-AN-RDS23A

FUNCTIONAL DESIGN REQUIREMENTS:

<p>This activity space provides facilities needed for the following activities:</p> <ul style="list-style-type: none"> a. Pharmacy staff coordinates activities. b. Pharmacy staff prepares required reports. c. Pharmacy staff performs pharmaceutical research activities. d. Pharmacy staff performs administrative functions. <p>People Involved:</p> <ul style="list-style-type: none"> 1 x Pharmacist 1 x Aide Clerks Visitors <p>Planning Relationships:</p> <ul style="list-style-type: none"> a. Close to Patient Dispensing Area. b. Close to Chief Pharmacist's Office. 	EQUIPMENT AND ACCESSORY CHECKLIST	QUANTITY	REMARKS
	Typewriter Calculating machine Sink in counter	1 1 1	
	FURNITURE AND FIXTURE CHECKLIST	QUANTITY	REMARKS
	Counter, 900mm high, with 300mm deep cabinets below Chair, upright, stacking Typewriter table, 400x800 Counter, cabinets below Lavatory Water closet	3 1 1 1	
	ADDITIONAL EQUIPMENT AND ENGINEERING TERMINALS	QUANTITY	REMARKS
	Rail, curtain, window Outlet, 10A, 2P, 240V, duplex Outlet, 15A, 2P, 240V, single	2 3 1	grounding type, parallel slots grounding type tandem slots

Hospital Tertiary, 100-Bed	ROOM DATA SHEET		Department of Health HEALTH INFRASTRUCTURE SERVICE
Updated Reference: May 1992	Department: PHARMACY	Room Title: STAFF WORK AREA	Reference Sheet Number: 100B-AN-RDS238
TECHNICAL DESIGN DATA:			
ENVIRONMENTAL CONDITIONS	DESIGN DATA	ENVIRONMENTAL CONDITIONS	DESIGN DATA
AIR:		LIGHTING AND VISUAL	
Outdoor air temperature (deg. C)	ave. local station temp. reading	General illumination (LUX)	250
Room Temperature	25	Night illumination (LUX)	NA
Mechanical ventilation		Task illumination (LUX)	NA
Volume (cu.m./hr.-person)	12.75	Colour rendering	essential: DESIRABLE: unnecessary
Velocity (m/hr.)	750	Standby light	essential: DESIRABLE: unnecessary
Pressure		Emergency light	essential: DESIRABLE: unnecessary
Exhaust (psi)	NA	Daylight	essential: desirable: UNNECESSARY
Inlet (psi)	NA	View out	essential: DESIRABLE: unnecessary
% Dust filtration	93% - 99% @ 1 micron	Privacy	essential: DESIRABLE: unnecessary
Humidity (%RH)	50	Black out	essential: desirable: UNNECESSARY
Cooling load (TR)	1		
SOUND		SAFETY	
Acceptable sound level (db)	50	Accessible hot surface	NA
Speech privacy	essential: DESIRABLE: unnecessary	Maximum temperature (deg. C)	NA
Quality which cannot be tolerated	tonal impact	Domestic hot water	at sink and lavatory
		Maximum temperature (deg. C)	70
		Access limit	pharmacy staff
		Fire risk	LOW: medium: high
		Other risks	NA

Hospital: Tertiary, 100-Bed	ROOM DATA SHEET		Department of Health HEALTH INFRASTRUCTURE SERVICE
Updated Reference: May 1992	Department: PHARMACY	Room Title: STAFF WORK AREA	Reference Sheet Number: 100B-AN-RDS23C
TECHNICAL DESIGN DATA:		LAYOUT OF ROOM AND SPACE COMPONENTS:	
DIRECT SERVICES	DESIGN DATA	Scale 1:100 mts.	
Disposal	hospital solid waste type : A		
Hot water	at sink and lavatory		
Cold water	at sink and toilet fixtures		
Drainage	at sink, toilet fixtures and floor		
Gas	NA		
Compressed air	NA		
Steam	NA		
Others			
DIRECT DEMANDS ON FLOOR AND WALL			
Loading	NA		
Spillage	NA		
Foot traffic	light : MEDIUM : heavy		
Wheel traffic	NA		
Impacts	NA		
Abrasion	NA		
Easy maintenance	ESSENTIAL: desirable unnecessary	Key	
Vibration free	ESSENTIAL: desirable unnecessary	1. Counter, 900 mm high, w/300mm deep cabinets below	
Door set	ordinary access door	2. Chair, upright, stacking	
Windows	clear, solar control	3. Typewriter table, 400x800	
Internal glazing	nil	4. Sink in counter	
		5. Counter, cabinet below	
		SPACE DEMANDS (Total Minimum Space Required in sq.m.): 13.50	
		Space Components	Minimum Space Required/Component
		Work Area	11.26 sq. m.
		Toilet	2.24 sq. m.
		REGULATIONS AND NOTES:	

Hospital: Tertiary, 100-Bed	ROOM DATA SHEET		Department of Health HEALTH INFRASTRUCTURE SERVICE
Updated Reference: May 1992	Department: PHARMACY	Room Title: PATIENT DISPENSING AREA & DRUG INFO.	Reference Sheet Number: 100B-AN-RDS24A

FUNCTIONAL DESIGN REQUIREMENTS:

<p>This activity space provides facilities needed for the following activities:</p> <ul style="list-style-type: none"> a. Screens, fills, dispense drugs, medicines and biological. b. Supplies floor stocks to wards and other treatment areas. c. Provides drug information services. d. Preparation of I.V. admixtures. <p>People Involved:</p> <ul style="list-style-type: none"> 1 x Pharmacist 1 x Pharmacy Aide <p>Planning Relationships:</p> <ul style="list-style-type: none"> a. Close to Inpatient Nursing Wards b. Close to OPD and ER. 	EQUIPMENT AND ACCESSORY CHECKLIST	QUANTITY	REMARKS
	Refrigerator with freezer	1	
	FURNITURE AND FIXTURE CHECKLIST	QUANTITY	REMARKS
	Stool Open shelving Transaction counter with 300mm' deep cabinets and shelves below	2	
	ADDITIONAL EQUIPMENT AND ENGINEERING TERMINALS	QUANTITY	REMARKS
	Rail, curtain, window	1	
	Outlet, intercom	1	
	Outlet, 10A, 2P, 240V	3	grounding type, parallel slots
	Smoke detector		

Hospital		ROOM DATA SHEET		Department of Health	
Tertiary, 100-Bed				HEALTH INFRASTRUCTURE SERVICE	
Updated Reference: May 1992		Department: PHARMACY	Room Title: PATIENT DISPENSING AREA & DRUG INFO	Reference Sheet Number 100B-AN-RDS24B	
TECHNICAL DESIGN DATA:					
ENVIRONMENTAL CONDITIONS		DESIGN DATA		ENVIRONMENTAL CONDITIONS	
AIR				LIGHTING AND VISUAL	
Outdoor air temperature (deg. C)		ave. local station temp. reading		General illumination (LUX)	
				500	
Room Temperature:		25		Night illumination (LUX)	
				NA	
Mechanical ventilation:				Task illumination (LUX)	
				1000	
Volume (cu.m./hr.-person)		12.75		Colour rendering	
				essential DESIRABLE unnecessary	
Velocity (m.hr.)		900		Standby light	
				essential DESIRABLE unnecessary	
Pressure:				Emergency light	
				essential DESIRABLE unnecessary	
Exhaust (psi)		NA		Daylight	
				essential DESIRABLE unnecessary	
Inlet (psi)		NA		View out	
				essential desirable: UNNECESSARY	
% Dust filtration		93% - 99% @ 1 micron		Privacy	
				essential desirable: UNNECESSARY	
Humidity (%RH)		50		Black-out	
				essential desirable: UNNECESSARY	
Cooling load (TR)		1			
SOUND				SAFETY	
Acceptable sound level (db)		50		Accessible hot surface:	
				NA	
Speech privacy		essential desirable: UNNECESSARY		Maximum temperature (deg. C)	
				NA	
Quality which cannot be		tonal impact		Domestic hot water:	
tolerated				Maximum temperature (deg. C)	
				NA	
				Access limit	
				pharmacy staff	
				Fire risk	
				LOW medium : high	
				Other risks	
				NA	

Hospital: Tertiary, 100-Bed	ROOM DATA SHEET		Department of Health HEALTH INFRASTRUCTURE SERVICE
Updated Reference: May 1992	Department: PHARMACY	Room Title: PATIENT DISPENSING AREA & DRUG INFO.	Reference Sheet Number: 100B-AN-RDS24C
TECHNICAL DESIGN DATA:		LAYOUT OF ROOM AND SPACE COMPONENTS:	
DIRECT SERVICES	DESIGN DATA	<p>Scale 1:100 mts.</p>	
Disposal	hospital solid waste type : A, G		
Hot water	NA		
Cold water	NA		
Drainage	NA		
Gas	NA		
Compressed air	NA		
Steam	NA		
Others			
DIRECT DEMANDS ON FLOOR AND WALL			
Loading	NA		
Spillage	NA		
Foot traffic	light : MEDIUM : heavy		
Wheel traffic	light : MEDIUM : heavy		
Impacts	NA		
Abrasion	NA		
Easy maintenance	ESSENTIAL: desirable: unnecessary	SPACE DEMANDS (Total Minimum Space Required in sq.m.) : 13.50	
Vibration free	ESSENTIAL: desirable: unnecessary	Space Components	Minimum Space Required/Component
Door sets	ordinary access door		
Windows	clear, solar control	REGULATIONS AND NOTES:	
Internal glazing	clear		

Key

- 1. Open shelving
- 2. Glass partition with transaction windows/openings
- 3. Transaction counter with 300mm deep cabinets and shelves below
- 4. Refrigerator with freezer
- 5. Stool

Hospital: Tertiary, 100-Bed	ROOM DATA SHEET		Department of Health HEALTH INFRASTRUCTURE SERVICE
Updated Reference: May 1992	Department: PHARMACY	Room Title: RECEIVING/BREAKOUT/ INSPECTION AREA	Reference Sheet Number: 100B-AN-RDS25A
FUNCTIONAL DESIGN REQUIREMENTS:			
<p>This activity space provides facilities needed for the following activities:</p> <ul style="list-style-type: none"> a. Pharmacist receives pharmaceutical & biological deliveries. b. Pharmacist inspects pharmaceutical and biological deliveries <p>People Involved:</p> <ul style="list-style-type: none"> 1 x Pharmacist 1 x Storekeeper <p>Planning Relationships:</p> <ul style="list-style-type: none"> a. Adjacent to Flammable Storage. b. Adjacent to Bulk Storage. 	EQUIPMENT AND ACCESSORY CHECKLIST	QUANTITY	REMARKS
	FURNITURE AND FIXTURE CHECKLIST	QUANTITY	REMARKS
	Counter, 900mm. high shelving below	1	
	Chair, upright, stacking	1	
	ADDITIONAL EQUIPMENT AND ENGINEERING TERMINALS	QUANTITY	REMARKS
	Outlet, 10A, 2P, 240V, duplex	2	grounding type, parallel slots

Hospital	ROOM DATA SHEET		Department of Health HEALTH INFRASTRUCTURE SERVICE
Tertiary, 100-Bed			
Updated Reference: May 1992	Department: PHARMACY	Room Title: RECEIVING/BREAKOUT/ INSPECTION AREA	Reference Sheet Number: 100B-AN-RDS25B
TECHNICAL DESIGN DATA:			
ENVIRONMENTAL CONDITIONS	DESIGN DATA	ENVIRONMENTAL CONDITIONS	DESIGN DATA
AIR:		LIGHTING AND VISUAL	
Outdoor air temperature (deg. C)	ave. local station temp. reading	General illumination (LUX)	500
Room Temperature	ambient	Night illumination (LUX)	NA
Mechanical ventilation		Task illumination (LUX)	NA
Volume (cu.m./hr.-person)	NA	Colour rendering	ESSENTIAL: desirable: unnecessary
Velocity (m/hr.)	NA	Standby light	ESSENTIAL: desirable: unnecessary
Pressure:		Emergency light	essential: DESIRABLE: unnecessary
Exhaust (psi)	NA	Daylight	essential: desirable: UNNECESSARY
Inlet (psi)	NA	View out	essential: desirable: UNNECESSARY
% Dust filtration	NA	Privacy	essential: desirable: UNNECESSARY
Humidity (%RH)	NA	Black out	essential: desirable: UNNECESSARY
Cooling load (TR)	NA		
SOUND		SAFETY	
Acceptable sound level (db)	60	Accessible hot surface:	NA
Speech privacy	essential: desirable: UNNECESSARY	Maximum temperature (deg. C)	NA
Quality which cannot be	tonal impact	Domestic hot water:	NA
tolerated		Maximum temperature (deg. C)	NA
		Access limit	pharmacy staff
		Fire risk	LOW: medium: high
		Other risks	NA

Hospital: Tertiary, 100-Bed	ROOM DATA SHEET		Department of Health HEALTH INFRASTRUCTURE SERVICE						
Updated Reference: May 1992	Department: PHARMACY	Room Title: RECEIVING/BREAKOUT/ INSPECTION AREA	Reference Sheet Number: 100B-AN-RDS25C						
TECHNICAL DESIGN DATA:		LAYOUT OF ROOM AND SPACE COMPONENTS:							
DIRECT SERVICES	DESIGN DATA	<p style="text-align: right;">Scale 1:100 mts.</p>							
Disposal	hospital solid waste type : A,G								
Hot water	NA								
Cold water	NA								
Drainage	NA								
Gas	NA								
Compressed air	NA								
Steam	NA								
Others									
DIRECT DEMANDS ON FLOOR AND WALL									
Loading	light : medium : HEAVY	<p>Key</p> <p>1. Counter, 900mm. high, shelving below</p> <p>2. Chair, upright, stacking</p>							
Spillage	NA								
Foot traffic	light : MEDIUM : heavy								
Wheel traffic	light : MEDIUM : heavy								
Impacts	light : MEDIUM : heavy								
Abrasion	slight : OCCASIONAL : frequent								
Easy maintenance	ESSENTIAL : desirable : necessary								
Vibration free	ESSENTIAL : desirable : unnecessary								
Door set	ordinary access door								
Windows	nil								
Internal glazing	nil	<p>SPACE DEMANDS (Total Minimum Space Required in sq. m.) : 12.00</p> <table border="1"> <thead> <tr> <th>Space Components</th> <th>Minimum Space Required/Component</th> </tr> </thead> <tbody> <tr> <td> </td> <td> </td> </tr> <tr> <td> </td> <td> </td> </tr> </tbody> </table> <p>REGULATIONS AND NOTES:</p>		Space Components	Minimum Space Required/Component				
Space Components	Minimum Space Required/Component								

Hospital: Tertiary, 100-Bed	ROOM DATA SHEET		Department of Health HEALTH INFRASTRUCTURE SERVICE
Updated Reference: May 1992	Department: PHARMACY	Room Title: FLAMMABLE STORAGE	Reference Sheet Number: 100B-AN-RDS26A

FUNCTIONAL DESIGN REQUIREMENTS:				
<p>This activity space provides facilities needed for the following activities:</p> <p style="margin-left: 20px;">a. Storage of alcohol and volatile liquids.</p> <p>People Involved:</p> <p style="margin-left: 20px;">1 x Pharmacist 1 x Utility Worker</p> <p>Planning Relationships:</p> <p style="margin-left: 20px;">a. Close to Receiving/Breakout/Inspection Area</p>	EQUIPMENT AND ACCESSORY CHECKLIST	QUANTITY	REMARKS	
	FURNITURE AND FIXTURE CHECKLIST	QUANTITY	REMARKS	
	Open shelving			
	ADDITIONAL EQUIPMENT AND ENGINEERING TERMINALS	QUANTITY	REMARKS	
Rail, curtain, window	1			

Hospital	ROOM DATA SHEET		Department of Health
Tertiary, 100-Bed			HEALTH INFRASTRUCTURE SERVICE
Updated Reference: November 1991	Department: PHARMACY	Room Title: FLAMMABLE STORAGE	Reference Sheet Number: 100B-AN-RDS26B
TECHNICAL DESIGN DATA:			
ENVIRONMENTAL CONDITIONS	DESIGN DATA	ENVIRONMENTAL CONDITIONS	DESIGN DATA
AIR		LIGHTING AND VISUAL	
Outdoor air temperature (deg. C)	ave. local station temp. reading	General illumination (LUX)	150
Room Temperature	ambient	Night illumination (LUX)	NA
Mechanical ventilation		Task illumination (LUX)	NA
Volume (cu.m./hr./person)	NA	Colour rendering	essential: DESIRABLE: unnecessary
Velocity (m/hr.)	NA	Standby light	essential: desirable : UNNECESSARY
Pressure:		Emergency light	essential: desirable : UNNECESSARY
Exhaust (psi)	NA	Daylight	essential: desirable : UNNECESSARY
Inlet (psi)	NA	View out	essential: desirable : UNNECESSARY
% Dust filtration	NA	Privacy	essential: desirable : UNNECESSARY
Humidity (%RH)	NA	Black out	essential: desirable : UNNECESSARY
Cooling load (TR)	NA		
SOUND		60 SAFETY	
Acceptable sound level (db)	essential: desirable: UNNECESSARY	Accessible hot surface:	NA
Speech privacy	NA	Maximum temperature (deg. C)	NA
Quality which cannot be		Domestic hot water:	NA
tolerated		Maximum temperature (deg. C)	NA
		Access limit	pharmacy staff
		Fire risk:	low : medium : HIGH
		Other risks	exposure to hazardous chemicals

Hospital: Tertiary, 100-Bed	ROOM DATA SHEET		Department of Health HEALTH INFRASTRUCTURE SERVICE								
Updated Reference: May 1992	Department: PHARMACY	Room Title: FLAMMABLE STORAGE	Reference Sheet Number: 100B-AN-RDS26C								
TECHNICAL DESIGN DATA:		LAYOUT OF ROOM AND SPACE COMPONENTS:									
DIRECT SERVICES	DESIGN DATA	Scale 1:100 mts.									
Disposal	hospital solid waste type : A,G										
Hot water	NA										
Cold water	NA										
Drainage	NA										
Gas	NA										
Compressed air	NA										
Steam	NA										
Others											
DIRECT DEMANDS ON FLOOR AND WALL				Key 1 Open shelving							
Loading	light : MEDIUM : heavy										
Spillage	NA										
Foot traffic	LIGHT : medium : heavy										
Wheel traffic	NA										
Impacts	LIGHT : medium : heavy										
Abrasion	SLIGHT : occasional : frequent										
Easy maintenance	ESSENTIAL : desirable : unnecessary										
Vibration free	ESSENTIAL : desirable : unnecessary										
Door set	ordinary access door										
Windows	clear, solar control	SPACE DEMANDS (Total Minimum Space Required in sq.m.): 5.25 <table border="1" style="width: 100%; border-collapse: collapse;"> <thead> <tr> <th style="width: 50%;">Space Components</th> <th style="width: 50%;">Minimum Space Required/Component</th> </tr> </thead> <tbody> <tr> <td> </td> <td> </td> </tr> <tr> <td> </td> <td> </td> </tr> <tr> <td> </td> <td> </td> </tr> </tbody> </table>		Space Components	Minimum Space Required/Component						
Space Components	Minimum Space Required/Component										
Internal glazing	nil	REGULATIONS AND NOTES: Hazardous location, class 1, division 1									

Hospital: Tertiary, 100-Bed	R O O M D A T A S H E E T		Department of Health HEALTH INFRASTRUCTURE SERVICE
Updated Reference: May 1992	Department: PHARMACY	Room Title: BULK STORAGE	Reference Sheet Number: 100B-AN-RDS27A

FUNCTIONAL DESIGN REQUIREMENTS:

<p>This activity space provides facilities needed for the following activities:</p> <p>a. Storage of pharmaceuticals.</p> <p>People Involved:</p> <p>1 x Pharmacist 1 x Utility Worker</p> <p>Planning Relationships:</p> <p>a. Adjacent to Receiving / Breakout / Inspection Area</p>	EQUIPMENT AND ACCESSORY CHECKLIST	QUANTITY	REMARKS
	Wooden palletes	2	
	FURNITURE AND FIXTURE CHECKLIST	QUANTITY	REMARKS
	Shelving, adjustable, rail mounted	4	
	ADDITIONAL EQUIPMENT AND ENGINEERING TERMINALS	QUANTITY	REMARKS
	Outlet, 10A, 2P, 240V, duplex	1	grounding type parallel slots

Hospital	ROOM DATA SHEET		Department of Health HEALTH INFRASTRUCTURE SERVICE
Tertiary, 100-Bed			
Updated Reference: May 1992	Department: PHARMACY	Room Title: BULK STORAGE	Reference Sheet Number: 100B-AN-RDS27B
TECHNICAL DESIGN DATA:			
ENVIRONMENTAL CONDITIONS	DESIGN DATA	ENVIRONMENTAL CONDITIONS	DESIGN DATA
AIR:		LIGHTING AND VISUAL	
Outdoor air temperature (deg. C)	ave. local station temp. reading	General illumination (LUX)	150
Room Temperature	ambient	Night illumination (LUX)	NA
Mechanical ventilation		Task illumination (LUX)	NA
Volume (cu.m./hr.-person)	NA	Colour rendering	essential: DESIRABLE: unnecessary
Velocity (m.hr.)	NA	Standby light	essential desirable UNNECESSARY
Pressure:		Emergency light	essential desirable UNNECESSARY
Exhaust (psi)	NA	Daylight	essential desirable UNNECESSARY
Inlet (psi)	NA	View out	essential desirable UNNECESSARY
% Dust filtration	NA	Privacy	essential desirable UNNECESSARY
Humidity (%RH)	NA	Black out	essential desirable UNNECESSARY
Cooling load (TR)	NA		
SOUND	60	SAFETY	
Acceptable sound level (db)	essential, desirable, UNNECESSARY	Accessible hot surface:	NA
Speech privacy	NA	Maximum temperature (deg. C)	NA
Quality which cannot be		Domestic hot water:	NA
tolerated		Maximum temperature (deg. C)	NA
		Access limit	pharmacy staff
		Fire risk	low: MEDIUM: high
		Other risks	NA

Hospital. Tertiary, 100-Bed	ROOM DATA SHEET		Department of Health HEALTH INFRASTRUCTURE SERVICE						
Updated Reference: May 1992	Department: PHARMACY	Room Title: BULK STORAGE	Reference Sheet Number: 100B-AN-RDS27C						
TECHNICAL DESIGN DATA:		LAYOUT OF ROOM AND SPACE COMPONENTS:							
DIRECT SERVICES	DESIGN DATA	Scale 1:100 mts.							
Disposal	hospital solid waste type : A,G								
Hot water	NA								
Cold water	NA								
Drainage	NA								
Gas	NA								
Compressed air	NA								
Steam	NA								
Others									
DIRECT DEMANDS ON FLOOR AND WALL				Key 1 Shelving, adjustable, rail mounted 2. Wooden pallettes					
Loading	light : MEDIUM : heavy								
Spillage	NA								
Foot traffic	LIGHT : medium : heavy								
Wheel traffic	NA								
Impacts	SLIGHT : occasional : frequent								
Abrasion	LIGHT : medium : heavy								
Easy maintenance	ESSENTIAL desirable: unnecessary								
Vibration free	ESSENTIAL: desirable: unnecessary								
Door set	ordinary access door								
Windows	clear, solar control	SPACE DEMANDS (Total Minimum Space Required in sq.m.): 12.75 <table border="1" style="width: 100%; border-collapse: collapse;"> <thead> <tr> <th>Space Components</th> <th>Minimum Space Required/Component</th> </tr> </thead> <tbody> <tr> <td> </td> <td> </td> </tr> <tr> <td> </td> <td> </td> </tr> </tbody> </table>		Space Components	Minimum Space Required/Component				
Space Components	Minimum Space Required/Component								
Internal glazing	nil								
		REGULATIONS AND NOTES:							

Hospital: Tertiary, 100-Bed	ROOM DATA SHEET		Department of Health HEALTH INFRASTRUCTURE SERVICE
Updated Reference: May 1992.	Department: PHARMACY	Room Title: EXTEMPORANEOUS PREPARATION AREA	Reference Sheet Number: 100B-AN-RDS28A

FUNCTIONAL DESIGN REQUIREMENTS:

<p>This activity space provides facilities needed for the following activities:</p> <ul style="list-style-type: none"> a. Compounding of extemporaneous pharmaceutical preparations b. Solutions are prepared and/or sterilized <p>People Involved:</p> <ul style="list-style-type: none"> 1 x Pharmacist 1 x Pharmacy Aide <p>Planning Relationships:</p> <ul style="list-style-type: none"> a. Adjacent to Distribution Area. b. Adjacent to Bulk Storage. 	EQUIPMENT AND ACCESSORY CHECKLIST	QUANTITY	REMARKS
	Hood, laminar airflow	1	
	Cart, utility	1	
	Sink in counter	1	
	Heating facility, 2-element	1	
	FURNITURE AND FIXTURE CHECKLIST	QUANTITY	REMARKS
	Counter, 900mm high, with adjustable shelving below		
	Cabinet, overhead, wall mounted	1	
	Transaction counter	2	
	Stool	2	
	ADDITIONAL EQUIPMENT AND ENGINEERING TERMINALS	QUANTITY	REMARKS
	Rail, curtain, window	1	
	Outlet, intercom	1	
	Outlet, 10A, 2P, 240V, duplex	3	grounding type, parallel slots
	Outlet, 10A, 2P, 240V, single	1	grounding type tandem slots

Hospital: Tertiary, 100-Bed	ROOM DATA SHEET		Department of Health HEALTH INFRASTRUCTURE SERVICE
Updated Reference: May 1992	Department: PHARMACY	Room Title: EXTEMPORANEOUS PREPARATION AREA	Reference Sheet Number: 100B-AN-RDS28B
TECHNICAL DESIGN DATA:			
ENVIRONMENTAL CONDITIONS	DESIGN DATA	ENVIRONMENTAL CONDITIONS	DESIGN DATA
AIR		LIGHTING AND VISUAL	
Outdoor air temperature (deg. C)	ave. local station temp. reading	General illumination (LUX)	500
Room Temperature (deg. C)	25	Night illumination (LUX)	NA
Mechanical ventilation:		Task illumination (LUX)	1000
Volume (cu.m./hr./person)	12.75	Colour rendering	ESSENTIAL : desirable : unnecessary
Velocity (m./hr.)	900	Standby light	ESSENTIAL : desirable : unnecessary
Pressure:		Emergency light	ESSENTIAL : desirable : unnecessary
Exhaust (psi)	6 mm. Hg.	Daylight	essential : desirable : UNNECESSARY
Inlet (psi)	6 mm. Hg.	View out	essential : desirable UNNECESSARY
%Dust filtration	93% - 99% @ 1 micron	Privacy	essential : DESIRABLE : unnecessary
Humidity (%RH)	50	Black out	essential : desirable UNNECESSARY
Cooling load (TR)	1		
SOUND		SAFETY	
Acceptable sound level (db)	50	Accessible hot surface:	heating facility
Speech privacy	essential : DESIRABLE : unnecessary	Maximum temperature (deg. C)	100
Quality which cannot be tolerated	tonal impact	Domestic hot water:	at sink
		Maximum temperature (deg. C)	70
		Access limit	pharmacy staff
		Fire risk	low : medium : HIGH
		Other risks	NA

Hospital: Tertiary, 100-Bed		ROOM DATA SHEET		Department of Health HEALTH INFRASTRUCTURE SERVICE	
Updated Reference: May 1992		Department: PHARMACY	Room Title: EXTEMPORANEOUS PREPARATION AREA		Reference Sheet Number: 100B-AN-RDS28C
TECHNICAL DESIGN DATA:			LAYOUT OF ROOM AND SPACE COMPONENTS:		
DIRECT SERVICES:		DESIGN DATA		Scale 1:100 mts.	
Disposal	hospital solid waste type : A,F,G				
Hot water	required at sink				
Cold water	required at sink				
Drainage	required at sink				
Gas	NA				
Compressed air	NA				
Steam	NA				
Others					
DIRECT DEMANDS ON FLOOR AND WALL					
Loading	NA				
Spillage	SLIGHT : occasional : Frequent				
Foot traffic	LIGHT : medium : heavy				
Wheel traffic	light : MEDIUM : heavy				
Impacts	NA				
Abrasion	NA				
Easy maintenance	ESSENTIAL desirable unnecessary				
Vibration free	ESSENTIAL desirable unnecessary				
Door set	cart access				
Windows	clear, solar control				
Internal glazing	clear				
			Key 1. Cart, utility 2. Counter, 900mm. high, with adjustable shelving below 3. Cabinet, overhead, wall mounted 4. Sink in counter 5. Heating facility, 2-element 6. Transaction counter 7. Stool 8. Hood, luminaire airflow		
SPACE DEMANDS (Total Minimum Space Required in sq.m.): 12.00					
Space Components		Minimum Space Required/Component			
REGULATIONS AND NOTES					

Hospital	ROOM DATA SHEET		Department of Health HEALTH INFRASTRUCTURE SERVICE
Tertiary, 100-Bed			
Updated Reference: May 1992	Department: PHARMACY	Room Title: DISTRIBUTION AREA	Reference Sheet Number: 100B-AN-RDS29B
TECHNICAL DESIGN DATA:			
ENVIRONMENTAL CONDITIONS	DESIGN DATA	ENVIRONMENTAL CONDITIONS	DESIGN DATA
AIR		LIGHTING AND VISUAL	
Outdoor air temperature (deg. C)	ave. local station temp. reading	General illumination (LUX)	250
Room Temperature	25	Night illumination (LUX)	NA
Mechanical ventilation		Task illumination (LUX)	NA
Volume (cu.m./hr./person)	12.75	Colour rendering	essential DESIRABLE unnecessary
Velocity (m/hr.)	300	Standby light	essential DESIRABLE unnecessary
Pressure		Emergency light	essential DESIRABLE unnecessary
Exhaust (psi)	NA	Daylight	essential desirable UNNECESSARY
Inlet (psi)	NA	View out	essential desirable UNNECESSARY
% Dust filtration	93% - 99% @ 1 micron	Privacy	essential desirable UNNECESSARY
Humidity (%RH)	50	Black out	essential desirable UNNECESSARY
Cooling load (TR)	1		
SOUND		SAFETY	
Acceptable sound level (db)	50	Accessible hot surface:	NA
Speech privacy	essential desirable UNNECESSARY	Maximum temperature (deg. C)	NA
Quality which cannot be tolerated	NA	Domestic hot water	NA
		Maximum temperature (deg. C)	NA
		Access limit	pharmacy staff
		Fire risk	LOW medium high
		Other risks	NA

Hospital: Tertiary, 100-Bed	ROOM DATA SHEET		Department of Health HEALTH INFRASTRUCTURE SERVICE
Updated Reference: May 1992	Department: PHARMACY	Room Title: DISTRIBUTION AREA	Reference Sheet Number: 100B-AN-RDS29C
TECHNICAL DESIGN DATA:		LAYOUT OF ROOM AND SPACE COMPONENTS:	
DIRECT SERVICES	DESIGN DATA	Scale 1:100 mts.	
Disposal	hospital solid waste type : A,G		
Hot water	NA		
Cold water	NA		
Drainage	NA		
Gas	NA		
Compressed air	NA		
Steam	NA		
Others			
DIRECT DEMANDS ON FLOOR AND WALL			
Loading	LIGHT : medium : heavy		
Spillage	NA		
Foot traffic	LIGHT : medium : heavy		
Wheel traffic	LIGHT : medium : heavy		
Impacts	NA		
Abrasion	NA		
Easy maintenance	ESSENTIAL: desirable: unnecessary	SPACE DEMANDS (Total Minimum Space Required in sq m.): 18.00	
Vibration free	ESSENTIAL: desirable: unnecessary	Space Components	Minimum Space Required/Component
Door set	nil, open to circulation		
Windows	clear, solar control	REGULATIONS AND NOTES:	
Internal glazing	nil		

Hospital: Tertiary, 100-Bed	DEPARTMENT DATA SHEET	Department of Health HEALTH INFRASTRUCTURE SERVICE
Updated Reference: May 1992	Department: OUTPATIENT	Reference Sheet Number: 100B-AN-DDS04

LAYOUT PER DEPARTMENT SHOWING ROOMS AND SPACE COMPONENTS:

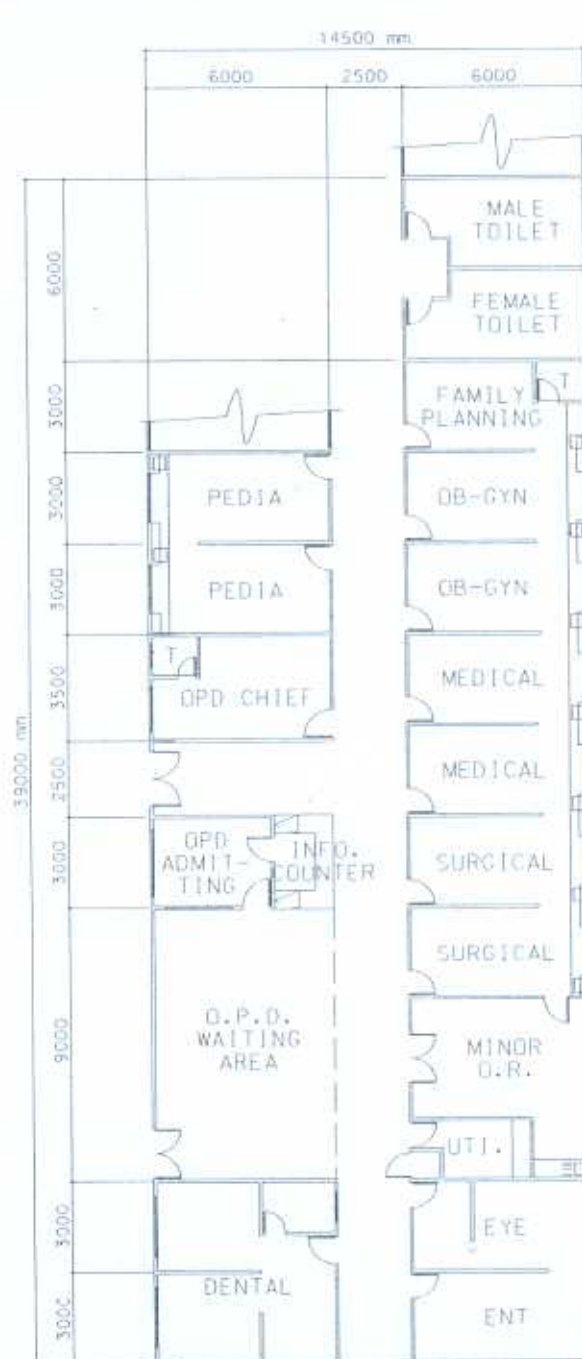

Hospital: Tertiary, 100-Bed	ROOM DATA SHEET		Department of Health HEALTH INFRASTRUCTURE SERVICE
Updated Reference: May 1992	Department: OUTPATIENT	Room Title: OPD WAITING AREA	Reference Sheet Number: 100B-AN-RDS30A

FUNCTIONAL DESIGN REQUIREMENTS:

<p>This activity space provides facilities needed for the following activities:</p> <ul style="list-style-type: none"> a. Patient await their turns to be interviewed and their cases be assessed at the triage. b. Patient await their turns to be attended to in any of the treatment rooms. <p>People Involved:</p> <p>40 x Outpatients and companions</p> <p>Planning Relationships:</p> <ul style="list-style-type: none"> a. Close to OPD Consultation Rooms. b. Adjacent to OPD Admitting/Information Counter. c. Close to other Ancillary Services. 	EQUIPMENT AND ACCESSORY CHECKLIST	QUANTITY	REMARKS
	Waste paper receptacle	2	
	FURNITURE AND FIXTURE CHECKLIST	QUANTITY	REMARKS
	Waiting bench, 500x2500	12	upholstered
	ADDITIONAL EQUIPMENT AND ENGINEERING TERMINALS	QUANTITY	REMARKS
	Rail, curtain, window	2	
	Outlet, 10A, 2P, 240V	3	grounding type, parallel slots
	Outlet, telephone	2	
	Electric fan	2	
	Paging system	1	

Hospital Tertiary, 100-Bed	ROOM DATA SHEET		Department of Health HEALTH INFRASTRUCTURE SERVICE
Updated Reference: May 1992	Department: OUTPATIENT	Room Title: OPD WAITING AREA	Reference Sheet Number: 100B-AN-RDS30B
TECHNICAL DESIGN DATA:			
ENVIRONMENTAL CONDITIONS	DESIGN DATA	ENVIRONMENTAL CONDITIONS	DESIGN DATA
AIR		LIGHTING AND VISUAL	
Outdoor air temperature (deg. C)	ave. local station temp. reading	General illumination (LUX)	150
Room Temperature	atmospheric	Night illumination (LUX)	50
Mechanical ventilation		Task illumination (LUX)	NA
Volume (cu.m./hr.-person)	12.75	Colour rendering	essential desirable UNNECESSARY
Velocity (m.hr.)	900	Standby light	essential DESIRABLE unnecessary
Pressure:		Emergency light	essential DESIRABLE unnecessary
Exhaust (psi)	NA	Daylight	essential: DESIRABLE: unnecessary
Inlet (psi)	NA	View out	essential: DESIRABLE: unnecessary
% Dust filtration	NA	Privacy	essential desirable UNNECESSARY
Humidity (%RH)	NA	Black out	essential desirable UNNECESSARY
Cooling load (TR)	NA		
SOUND		SAFETY	
Acceptable sound level (db)	60	Accessible hot surface:	NA
Speech privacy	essential: desirable: UNNECESSARY	Maximum temperature (deg. C)	NA
Quality which cannot be	tonal impact	Domestic hot water:	NA
tolerated		Maximum temperature (deg. C)	NA
		Access limit	general public
		Fire risk	LOW : medium : high
		Other risks	NA